



Oak Grove Plaza

2660 Reidville Road | Spartanburg, SC 29301



217-A E. Washington Street
Greenville, SC 29607
864 752 0300

Cortney Carter
1 864 752 0302
ccarter@collettre.com

Brayden Wynn, CCIM
1 864 752 0304
bwynn@collettre.com

Oak Grove Plaza

Property Overview

PROPERTY FEATURES

- Proposed up to ±18,000 SF retail spaces available for lease
- 1 acre outparcel opportunity
- 2,608 SF outparcel opportunity
- Ideally situated at Exit 22 off I-26
- Great visibility from Reidville Road
- Close proximity to W.O. Ezell Blvd retail corridor with the Westgate Mall, Target, Academy Sports, Costco, Walmart, and Sam's Club
- Nearby retailers/restaurants include Walgreens, Papa Johns, Dollar Tree, Dunkin', Hardee's, Tropical Grille, Domino's, CVS, Food Lion, QT, Denny's

DEMOGRAPHICS

	1 mile	3 miles	5 miles
Population	6,090	41,644	87,363
Projected Pop.	7,711	47,191	99,036
Employees	1,842	12,377	41,491
Avg HH Income	\$96,184	\$93,260	\$82,841

TRAFFIC COUNTS

Reidville Road	23,200 VPD
E. Blackstock Rd	19,700 VPD
I-26	47,800 VPD



Oak Grove Plaza

Demographics

KEY FACTS

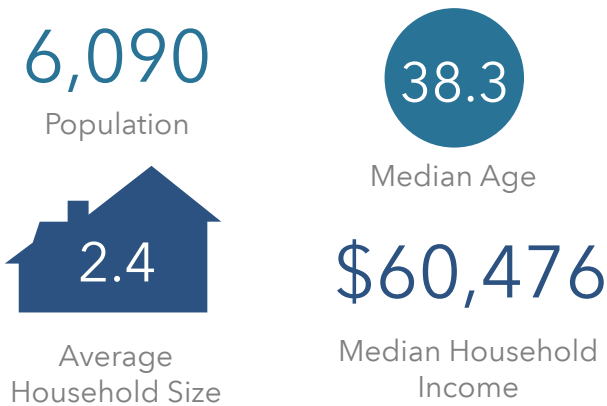

POPULATION BY AGE

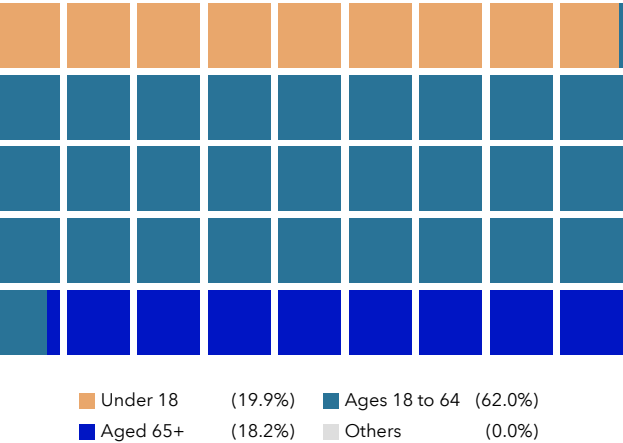

Population Trends and Key Indicators

2660 Reidville Rd, Spartanburg, South Carolina, 29301
Ring: 1 mile radius

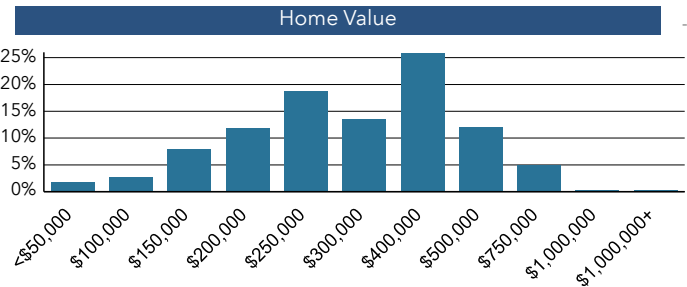

ANNUAL HOUSEHOLD SPENDING



EMPLOYMENT

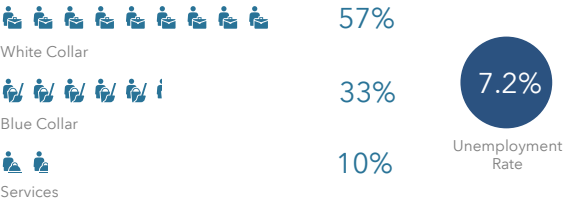

AVERAGE AMOUNT SPENT ON RETAIL GOODS



ANNUAL LIFESTYLE SPENDING

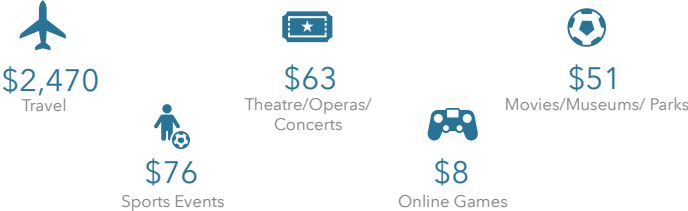

Oak Grove Plaza

Site Plan

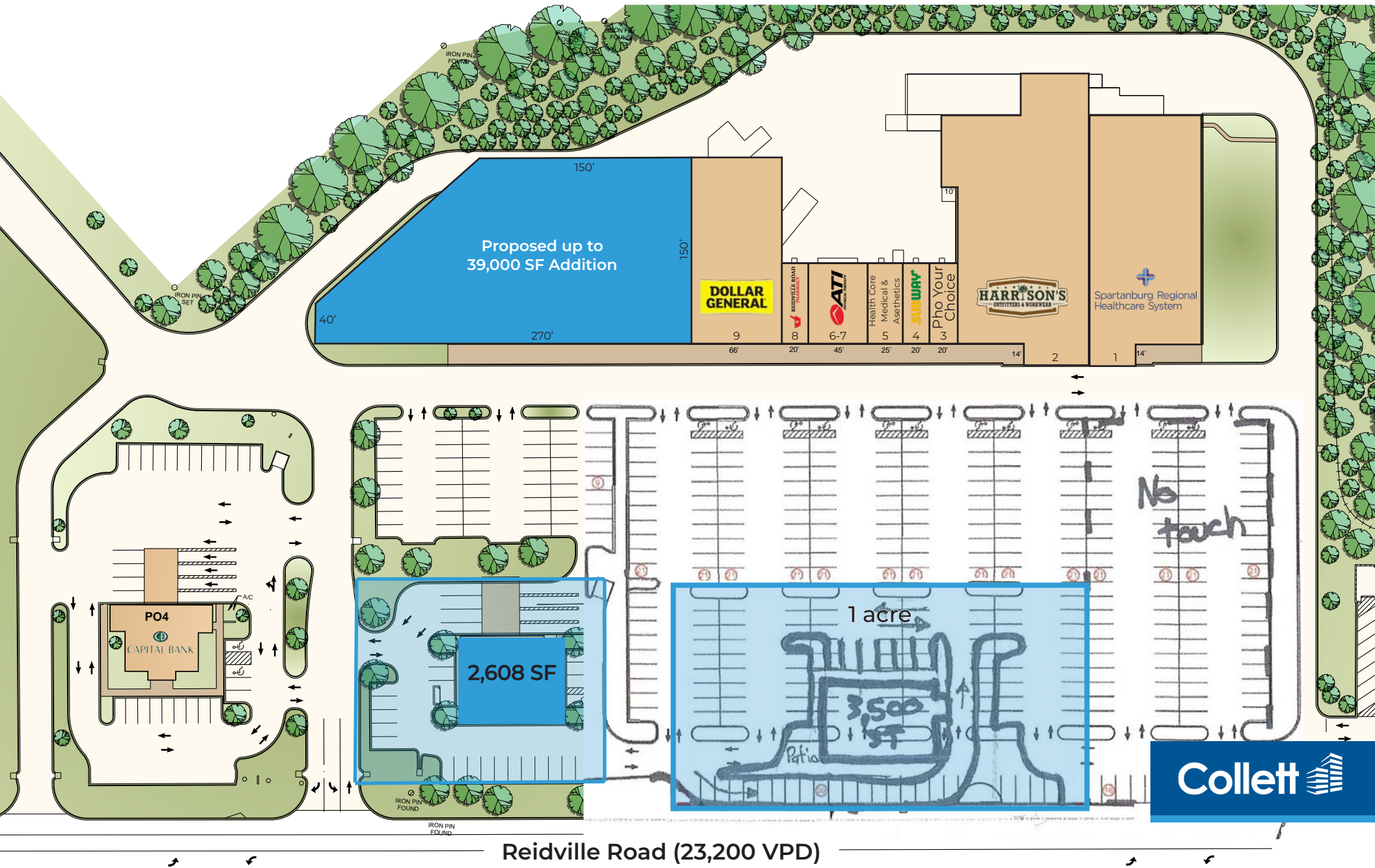

Oak Grove Plaza

Aerial

