

PORT ORANGE, FL

Yorktowne Blvd & Dunlawton Ave
Port Orange, FL

CONTACT | Frank Mellon
(C) 336.337.1558
fmellon@collettre.com



PROPERTY DETAILS

- Proposed Development located off Yorktowne Boulevard & Dunlawton Avenue in Port Orange, FL
- Proposed 1-story 4,500 SF Building

DEMOGRAPHIC SNAPSHOT (2019)

	3 mile	5 mile	10 mile
Population	60,571	107,062	211,633
2024 Projected Pop.	65,332	115,760	230,104
Avg. HH Income	\$64,881	\$68,042	\$63,060

TRAFFIC COUNTS

Dunlawton Avenue 48,000

118-C.W. UNION STREET
MORGANTON, NC 28655
MAILING: P.O. BOX 36799
CHARLOTTE, NC 28236-6799
WWW.COLLETTRE.COM

SOONER INVESTMENT
Commercial & Investment Real Estate

Collett



PORT ORANGE, FL

Site Plan

CONTACT | Frank Mellon
(C) 336.337.1558
fmellon@collettre.com

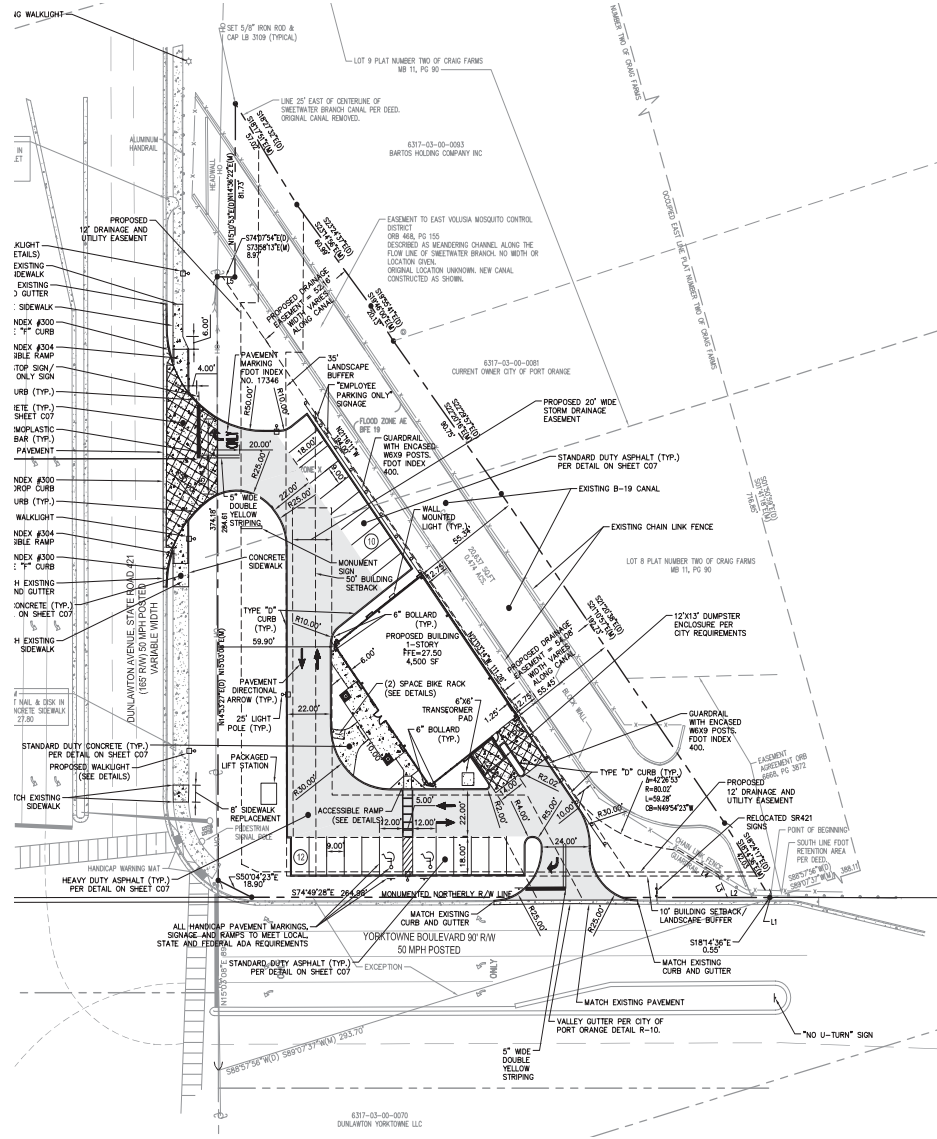

SOONER INVESTMENT
Commercial & Investment Real Estate



PORT ORANGE, FL

Aerial

CONTACT | Frank Mellon
(C) 336.337.1558
fmellon@collettre.com

